



OPzV250 (2V250Ah/10hr)



The battery is manufactured with PVC-SiO₂ separator and fumed silica. The tubular positive plate and pasted negative plate is applied. The batteries use silica gel to immobilize the electrolyte inside the battery. The proven silica gel technology improves battery cycle life and performance at various ambient temperatures.

Battery Construction

Component	Positive plate	Negative plate	Container	Cover	Safety valve	Terminal	Separator	Electrolyte
Raw material	Tubular	Lead	ABS	ABS	Rubber	Copper	PVC-SiO ₂	Fumed silica

General Feature

- The battery has a long service life, under float charging, ambient temperature 25°C, it can operate 20 years.
- Excellent Recovery from deep discharge and good deep discharge cycle capability.
- The battery has a low self-discharge, keep over 60% of the rated capacity after 2 years stored under 25°C
- High Reliability and Quality

SPECIFICATION

Nominal voltage 2V
 Number of cell 1
 Length(mm/inch) 206/8.11
 Width(mm/inch) 124/4.88
 Height(mm/inch) 355/14.0
 Total Height(mm/inch) 390/ 15.3
 Approx. Weight (kg/lbs) 23.5/ 51.7

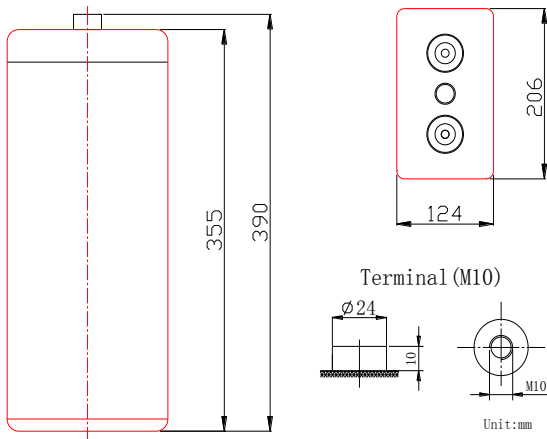

Performance Characteristics

Capacity 77 ℉(25℃)	10 hour rate (25A、 1.8V)	250Ah
	5 hour rate (43.6 A、 1.75V)	218Ah
	3 hour rate (64.3 A、 1.75V)	193Ah
	1 hour rate (148A、 1.60V)	148Ah
Internal Resistance	Full charged Battery 77 ℉(25℃): 0.7 mΩ	
Operating Temperature Range	Discharge: -20~65℃	
	Charge: -10~65℃	
	Storage: -20~65℃	
Self-Discharge 1.5% of capacity declined per month at 20℃ (average)		
Max. discharge current 77 ℉(25℃): 1800A(5S)		
Charge (Constant Voltage)	Float: 2.23~2.27 V/77 ℉/(25℃)	
	Cycle: 2.38~2.42 V/77 ℉/(25℃) Max. Current: 37.5A	

Discharge Constant Current (Amperes at 77 ℉ 25℃)

End	15mi	30mi	1h	3h	5h	10h	48h	100h
1.65v	315	235	148	67.1	47.3	---	---	---
1.70v	285	214	139	65.1	44.8	---	---	---
1.75v	269	203	130	64.3	43.6	25.5	---	---
1.80v	253	191	128	62.5	41.9	25.0	---	---
1.85v	236	174	122	61.1	40.9	23.6	6.00	3.00

Discharge Constant Current (Amperes at 77 ℉ 25℃)

End	15mi	30mi	1h	3h	5h	10h	48h	100h
1.65v	614	459	294	134	94.3	---	---	---
1.70v	556	417	276	129	89.3	---	---	---
1.75v	524	395	259	128	87.1	50.7	---	---
1.80v	492	373	254	124	83.6	49.8	---	---
1.85v	461	339	244	121	81.4	47.0	11.9	8.3

(Note) The above characteristics data are average values obtained within three charge/discharge cycles not the minimum values.

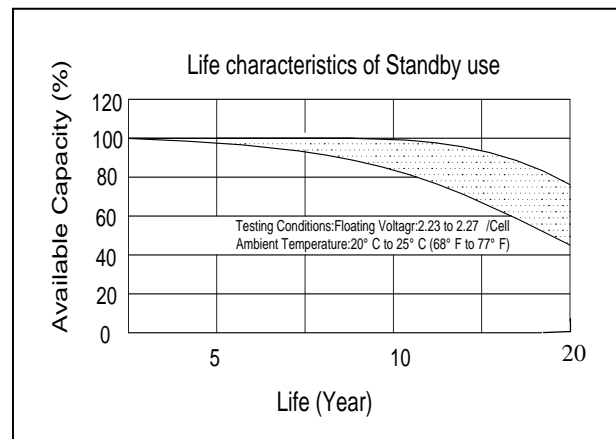
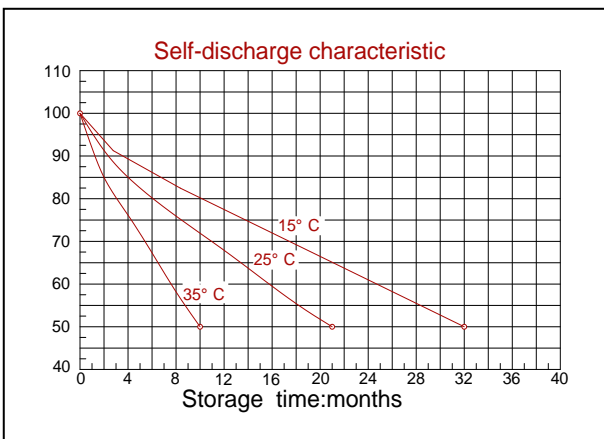
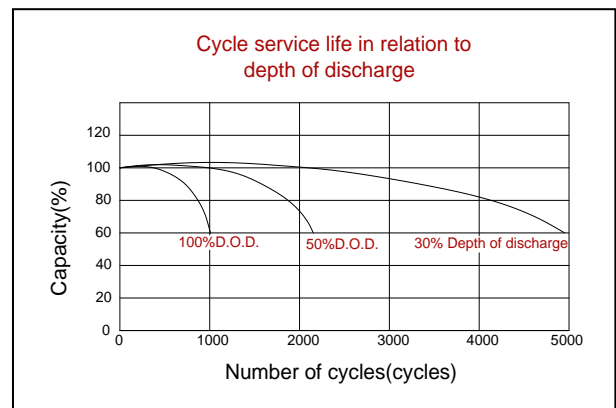
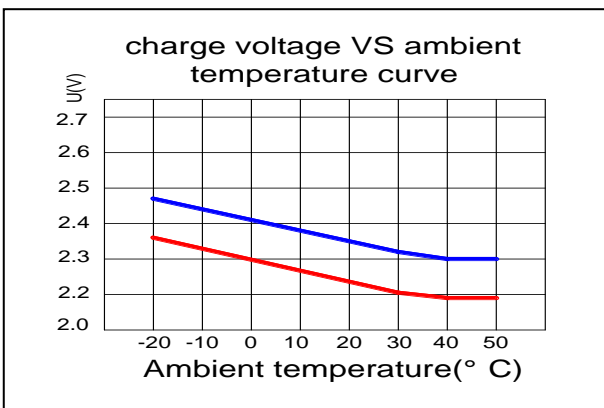
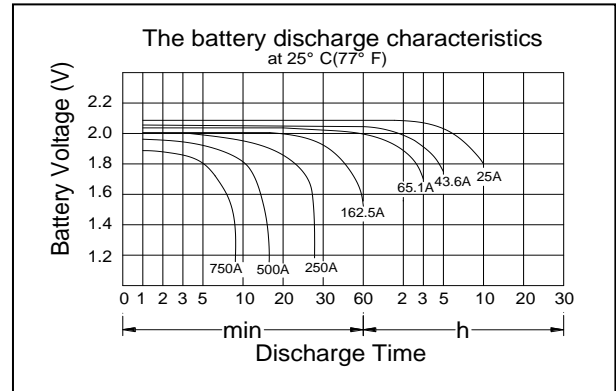
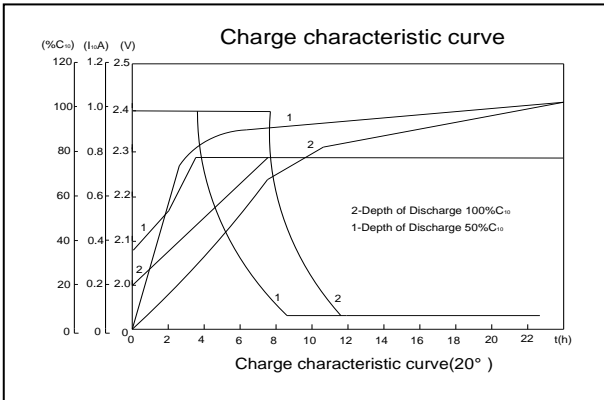

DONGGUAN OREMA POWER CO., LTD

Add: #1 Qilinling Road Shahu, Tangxia Town, Dongguan Guangdong China

TEL: +86-769- 3896 1163 +86-769- 3896 1168

FAX: +86-769- 3896 1169



www.oremabattery.com